

EURO-PRO 
select

OWNER'S MANUAL

Model FC251

120V., 60Hz., 12 Amps

***Bagless Cyclonic Canister
Aspirateur Cyclonique Sans Sac***

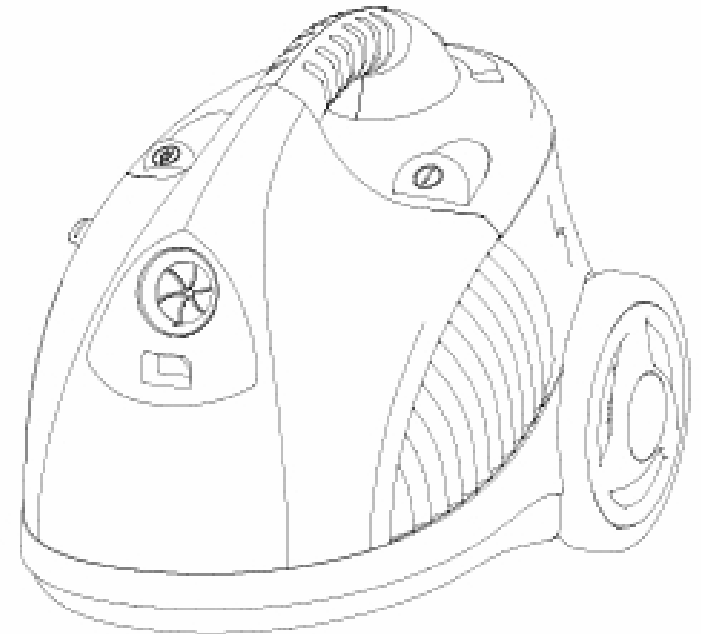

For information or assistance:

USA: EURO-PRO Operating LLC

94 Main Mill Street, Door 16

Plattsburgh, NY 12901

Tel: (800) 798-7398



ONE (1) YEAR LIMITED WARRANTY

EURO-PRO Operating LLC warrants this product to be free from defects in material and workmanship for a period of one (1) year from the date of the original purchase, when utilized for normal household use, subject to the following conditions, exclusions and exceptions.

If your appliance fails to operate properly while in use under normal household conditions within the warranty period, return the complete appliance and accessories, freight prepaid to EURO-PRO Operating LLC, 94 Main Mill Street, Door 16, Plattsburgh, NY 12901. If the appliance is found to be defective in material or workmanship, EURO-PRO Operating LLC will repair or replace it free of charge. Proof of purchase date and \$ 16.95 to cover the cost of return shipping and handling must be included. *

Non-durable parts including, without limitation, filters, brushes and electrical parts which normally require replacement are specifically excluded from warranty.

The liability of EURO-PRO Operating LLC is limited solely to the cost of the repair or replacement of the unit at our option. This warranty does not cover normal wear of parts and does not apply to any unit that has been tampered with or used for commercial purposes. This limited warranty does not cover damage caused by misuse, abuse, negligent handling or damage due to faulty packaging or mishandling in transit. This warranty does not cover damage or defects caused by or resulting from damages from shipping or repairs, service or alterations to the product or any of its parts, which have been performed by a repair person not authorized by EURO-PRO Operating LLC.

This warranty is extended to the original purchaser of the unit and excludes all other legal and/or conventional warranties. The responsibility of EURO-PRO Operating LLC if any, is limited to the specific obligations expressly assumed by it under the terms of the limited warranty. **In no event** is EURO-PRO Operating LLC liable for incidental or consequential damages of any nature whatsoever. Some states do not permit the exclusion or limitation of incidental or consequential damages, so the above may not apply to you.

This warranty gives you specific legal rights, and you may also have other rights which vary from state to state.

***Important:** Carefully pack item to avoid damage in shipping. Be sure to include proof of purchase date and to attach tag to item before packing with your name, complete address and phone number with a note giving purchase information, model number and what you believe is the problem with item. We recommend you insure the package (as damage in shipping is not covered by your warranty). Mark the outside of your package "ATTENTION CUSTOMER SERVICE". We are constantly striving to improve our products, therefore the specifications contained herein are subject to change without notice.



OWNERSHIP REGISTRATION CARD

Please fill out and mail the product registration card within ten (10) days of purchase. The registration will enable us to contact you in the unlikely event of a product safety notification. By returning this card you acknowledge to have read and understood the instructions for use, and warnings set forth in the accompanying instructions.

RETURN TO : EURO-PRO Operating LLC, 94 Main Mill Street, Door 16, Plattsburgh, NY 12901

Model FC251

Appliance model

Date purchased

Name of store

Owner's name

Address

City

State/ Prov.

Zip/Postal Code

FOR REPLACEMENT FILTER INFORMATION or for Technical Support for Model FC251

Call Customer Service: 1 (800) 798-7398

Monday to Friday 8:30 A.M. - 5:00 P.M. Eastern Standard Time

Please Note:

The HEPA Dust Cup Filter is washable. It should, however, be replaced every six (6) months to ensure peak performance of your vacuum.

The Post Motor Filter is washable. It should however be replaced every three (3) months to ensure peak performance of your vacuum.

Important:

Make sure that **ALL** filters are completely dry before re-installing back in the hand vacuum.

IMPORTANT SAFETY INSTRUCTIONS

When using your *Bagless Cyclonic Canister* vacuum, basic safety precautions should always be observed, including the following:

WARNING: To reduce the risk of fire, electrical shock, or injury:

1. Do not leave vacuum cleaner unattended when it is plugged in. Unplug from outlet when not in use and before filters.
2. To reduce the risk of electric shock – do not use outdoors or on wet surfaces.
3. Do not allow children to use as a toy. Close attention is necessary when used by or near children.
4. Use only as described in this manual. Use only manufacturer's recommended attachments.
5. Do not use with damaged cord or plug. Do not use vacuum cleaner if it has been dropped, damaged, left outdoors, or dropped into water. Return appliance to EURO-PRO Operating LLC for examination, repair or adjustment.
6. Do not pull or carry by cord. Do not use cord as a handle, close a door on cord, or pull cord around sharp edges or corners. Do not run appliance over cord. Keep cord away from heated surfaces.
7. Do not unplug by pulling on cord. To unplug, grasp the plug, not the cord.
8. Do not handle plug or vacuum cleaner with wet hands. Do not use outdoors or on wet surfaces.
9. Do not put any objects into openings. Do not use with any opening blocked and do not restrict airflow. Keep all openings free of dust, lint, hair, and anything that may reduce airflow.
10. Keep hair, loose clothing, fingers, and all parts of body away from openings and moving parts.
11. Do not pick up hot coals, cigarette butts, matches or any hot, smoking, or burning objects.
12. Do not pick up hard or sharp objects such as glass, nails, screws, coins, etc.
13. Do not use without filters in place.
14. Turn off all controls before plugging or unplugging vacuum cleaner.
15. Use extra care when vacuuming on stairs.
16. Do not pick up flammable or combustible materials (lighter fluid, gasoline, kerosene, etc.) or use in the presence of explosive liquids or vapor.
17. Do not pick up toxic material (chlorine bleach, ammonia, drain cleaner, etc.).
18. Do not use in an enclosed space filled with vapors given off by oil based paints, paint thinner, moth proofing substances, flammable dust, or other explosive or toxic vapors.
19. Always unplug this appliance before connecting or disconnecting vacuum hose. Do not allow plug to whip when rewinding.
20. Use only on dry, indoor surfaces.
21. Do not use for any purpose other than described in this user's guide.
22. Use **only** extension cords UL-rated or cUL at 15 amperes. extension cords rated for less amperage may overheat. Care should be taken to arrange the cord so that the cord cannot be pulled or tripped over.
23. **Do not** put any objects into openings. Do not use with any opening blocked. Keep free of dust, lint, hair and anything else that may reduce air flow.
24. Store your appliance indoors in a cool, dry area.
25. Keep your work area well lit.
26. **Do not** immerse the hand vacuum into water or other liquids.
27. Keep end of hose, wands and other openings away from your face and body.

SAVE THESE INSTRUCTIONS For Household Use Only

WARNING: To reduce the risk of electric shock, this appliance has a polarized plug (one blade is wider than the other). This plug will fit in a polarized outlet only one way. If the plug does not fit fully in the outlet, reverse the plug. If it still does not fit, contact a qualified electrician to install the proper outlet. Do not modify the plug in any way.

GETTING TO KNOW YOUR BAGLESS CYCLONIC CANISTER

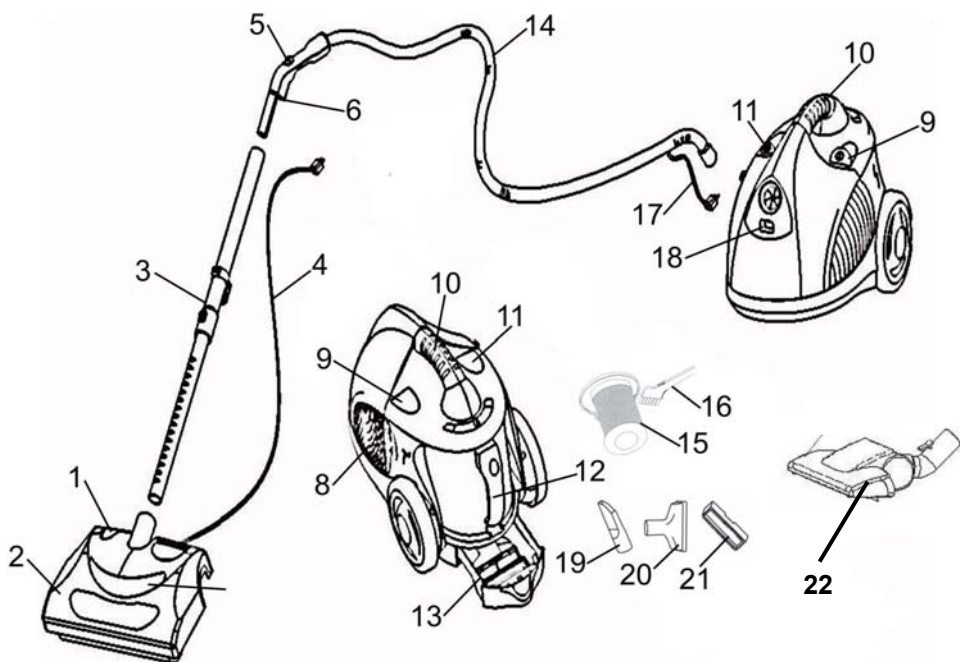

- | | |
|-------------------------------------|---|
| 1. Power Nozzle On/Off Button | 12. Dust Cup Handle |
| 2. Power Nozzle | 13. Tool Tray |
| 3. Telescopic Tube | 14. Flexible Hose |
| 4. Power Nozzle Power Cord | 15. HEPA Filter |
| 5. Manual Variable Suction Control | 16. HEPA Filter Cleaning Brush |
| 6. Receptacle for Power Nozzle Cord | 17. Connecting Power Cord |
| 7. Head Light | 18. Connecting Power Cord Receptacle |
| 8. Post Motor Filter Frame | 19. Crevice Tool |
| 9. Power On/Off Button | 20. Upholstery Brush |
| 10. Vacuum Handle | 21. Dusting Brush
(snaps on to upholstery brush) |
| 11. Cord Rewind Button | 22. Floor to Carpet Brush |

Technical Specifications

Main Unit: Voltage: 120V., 60Hz.
Power: 10.5 Amps

With Motorized Power Head: Voltage: 120V., 60 Hz.
Power: 12 Amps

OPERATING INSTRUCTIONS

PLEASE NOTE: The white pleated filter material in the HEPA Dust Cup Filter will discolor over time -This is NORMAL and will NOT affect the performance of the filter. If the HEPA Dust Cup Filter is properly "TapCleaned" after each use and suction does not return to 100%, then we suggest that the HEPA filter be "TapCleaned" vigorously until no more dust can be removed, then rinsed under the faucet and allowed to dry for 24 hours before refitting into the vacuum. (Fig. A) **This should be done once a month or when suction appears to be reduced.**

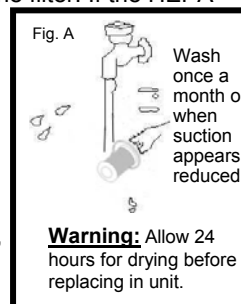

Important: The suction hole must be open, free of any obstructions at all times. Otherwise, the motor will overheat and could become damaged.

- Insert the dust cup cover and HEPA filter into the dust cup.
- Re-install dust cup and cover into vacuum. Close cover and re-attach hose.

IMPORTANT: Please note that there is a safety switch inside the vacuum where the dust cup is inserted to prevent the unit from being run without a dust cup in place. If the dust cup has not engaged this safety switch, the vacuum will **NOT** operate. Therefore, ensure that the dust cup is inserted firmly into the vacuum when assembling.

Changing & Cleaning the Post Motor Filter

The post motor filter is a washable filter but should be replaced every three (3) to six (6) months depending on usage. Never operate the vacuum without ALL the filters in place.

- Push the Power On/Off button to the "Off" position and disconnect the power cord from the wall outlet.

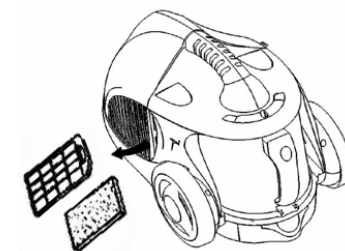

- Remove the filter from the filter grill. The post motor filter is located on the left hand side of the vacuum.
- Rinse the filter in lukewarm water and dry the filter completely. Do not use a washing machine to rinse the filter. Do not use a hair dryer to dry it. Air dry only. Never operate the vacuum without ALL the filters in place.
- When the filter is dry, replace into the filter grill and then into the unit.
- A severely solid or clogged filter should be thoroughly washed in lukewarm water. A mild detergent can be used if required. Ensure that the filter is completely dry before re-installing into the vacuum.



Please Note: The HEPA Dust Cup Filter is washable. It should, however, be replaced every six (6) months to ensure peak performance of your vacuum.

The Post Motor Filter is washable. It should however be replaced every three (3) months to ensure peak performance of your vacuum.

Important: Make sure that **ALL** filters are completely dry before re-installing back in the hand vacuum.

Important: All filters should be checked regularly for signs of damage, preferably after each cleaning task. The filters must be replaced immediately if they become damaged. Always disconnect the vacuum from the electrical outlet when checking the filters.

OPERATING INSTRUCTIONS

Removing & Cleaning the HEPA Dust Cup Filter

Warning: Always unplug the unit from electrical outlet before opening the Dust Cup (container).

1. Push the Power On/Off button to "Off" and disconnect the power cord from the wall outlet.
2. Remove the flexible hose.
3. Push the dust cup lock button located just underneath the dust cup and remove the dust cup.

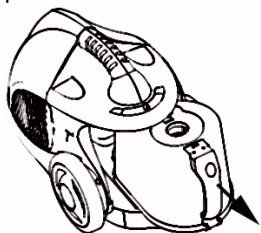

4. Hold dust cup over a waste basket and depress the dust cup "open" button to open the dust cup. Dispose of the dust inside.
Note: If dust is tightly packed and difficult to remove, tap the side of the dust cup lightly against the side of the garbage can.

5. To remove the HEPA dust cup filter from the dust cup, open the latch and lift the HEPA filter. See illustration below.

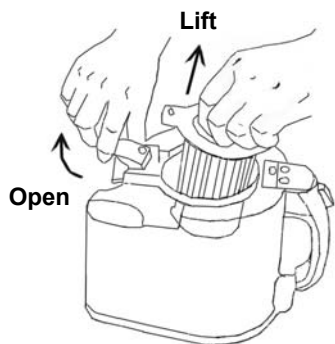

Warning: After each Use - Always remove the HEPA Filter from the Dust Cup, then vigorously "TapClean" HEPA Filter until no more dust can be removed.

Important: When "TapCleaning" the HEPA filter, hold the HEPA filter from the top rim and tap **ONLY** the bottom rim against the side of the waste container. **NEVER** tap directly on the pleated folds of the HEPA filter.

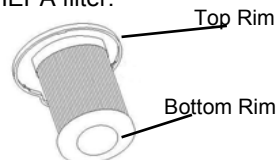

IMPORTANT, Please Note : The "TapClean" HEPA Dust Cup Filter will stop most of the tiniest dust particles from re-entering the air you breathe. In fact it stops 99.97% of all particles as small as 0.3 microns - many times smaller than a human hair!!! Because of this incredible filtration performance, the HEPA Dust Cup Filter will quickly accumulate, inside the white filter folds, many fine dust particles that are difficult to see but which will eventually block or reduce your suction power - if not cleaned properly. Clean the HEPA Filter as described in this section, then reconnect unit and proceed with vacuuming.)

6. Vigorously "TapClean" the HEPA Dust Cup Filter on a hard surface until no more dust is observed falling out from between the pleats of the filter. Please note that there is a filter brush included in the tool tray that you can use to clean the pleats of the HEPA filter. See illustrations at right.

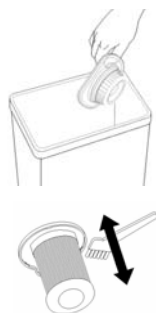

PRECAUTIONARY MEASURES

Important: If the suction opening of the unit, the hose or the chrome telescopic tube are **BLOCKED**, switch off the vacuum cleaner and remove the blocking substance before you start the unit again.

1. Do not operate the vacuum cleaner too close to heaters or radiators.



2. Before inserting the power plug into the wall outlet, make sure that your hands are dry.

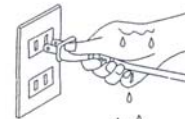

3. Before you start vacuuming, make sure to remove large or sharp objects that might damage the dust bag.

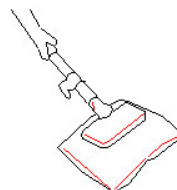

4. When pulling out the power plug from the wall outlet, pull the plug not the power cord.

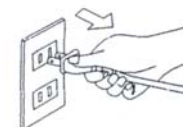

5. Do not pick up anything that is burning or smoking such as cigarettes, matches or hot ashes.

6. Do not use without all filters in place.

Note: This vacuum cleaner is equipped with a plug and power cord that retract automatically. If the cord or plug get damaged, it must be replaced by a qualified technician.

Warning: Hold the plug when rewinding the cord. Do not allow the cord to whip when rewinding.

OPERATING INSTRUCTIONS

Assembling Your Vacuum Cleaner

Note: Always remove the power plug from the wall outlet before assembling or removing accessories.

1. Attaching the Flexible Hose into the Vacuum

Connect the flexible hose into the air intake duct. Push in until you hear a "click", indicating it is in its locked position.

To remove the flexible hose first remove the power nozzle cable from the socket, then depress locking button and remove hose.

Connect the connecting power cord from the flexible hose to the power cord receptacle that is on the unit just below the air intake duct.

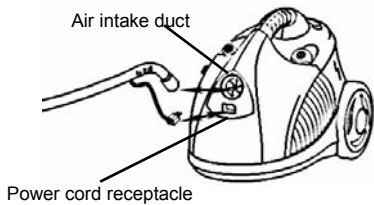

2. Fitting the Telescopic Tube to the Curved Wand / Hose Extension

Push the extension tube into the curved wand / hose extension, as shown in the illustration below.

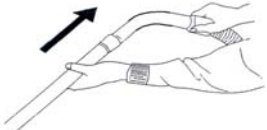

3. Extending the Chrome Telescopic Tube

Push forward on the plastic button and pull the inner chrome tube outward.

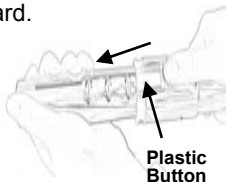

4. Fitting the Floor Brush to the Telescopic Tube

Push the telescopic tube into the floor brush as show in the illustration at right.

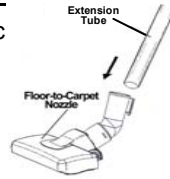

Using Power Nozzle

1. Connecting the power nozzle with the telescopic tube:
 - A) Depress the button on the telescopic tube and insert it into the slot on the power nozzle elbow.
 - B) Push the telescopic tube down until you hear a "click". (see illustration below).

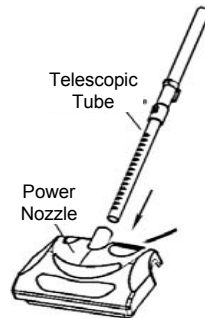

2. Insert the power nozzle cord plug into the power socket on the electric hose. To start power nozzle press the On/Off button that is located on the power nozzle.

OPERATING INSTRUCTIONS

Crevice Tool and Dusting Brush

1. Crevice Tool

For radiators, crevices, corners, baseboards and between cushions.



2. Upholstery Brush

The dusting brush is used for the furniture



3. Dusting Brush

The dusting brush is used for the furniture, venetian blinds, books, lamp shades and shelves. This is just snapped on to the upholstery brush.



Variable Suction Control

Your vacuum cleaner includes a variable suction control valve on the hose extension. The suction power can be adjusted by moving the slide to the desired position. For example. Less suction is required on upholstery and draperies compared to thick shag carpets, which require maximum suction.

Using your Vacuum

Note: Once all attachments are in place, unwind a sufficient length of cable and insert the plug into the wall outlet. A yellow mark on the power cord shows the ideal cable length. Don't pull the power cord beyond the red mark.

1. Insert the power plug into the wall outlet.
2. Press the Power On/Off button located on the unit to turn the vacuum cleaner "On".

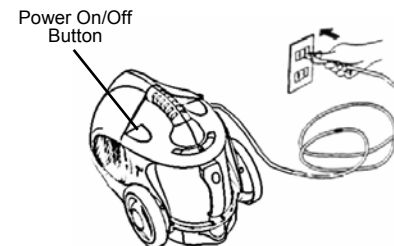

3. To rewind the power cord, press the cord rewind button with one hand and guide the power cord with the other hand to ensure that it does not whip causing damage or injury.

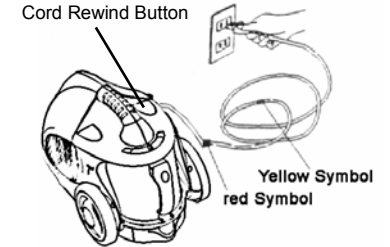

4. To adjust the suction, slide the variable suction control button to control the suction power of the vacuum cleaner. See illustration below.

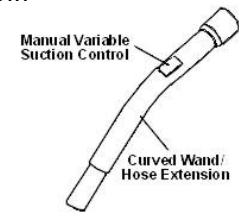

Motor Thermostat

Important: This motor is equipped with a motor protective thermostat. If for some reason the vacuum cleaner should overheat, the thermostat will automatically turn the unit off. Should this occur, unplug the vacuum cleaner from the wall outlet and turn off switch. Remove dust cup and empty. Clean dust cup filter. Allow the unit to cool for approximately 1 hour. To restart, re-plug into wall outlet and turn switch back on.